

## High Current

High Current	82
Junction Blocks	84
Junction Block – 8 Point	89

# High Current

High Current



- Quick & easy connection.
- Heavy duty construction.
- Silver-plated copper contacts provide low resistance for superior conductivity.



Contact : Silver-plated Copper  
 Operating Temperature : -20°C to 105°C  
 Approvals : High Current Connectors UL, RoHS



Rubber seals held in place by metal retainer

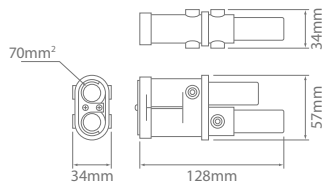

JS000

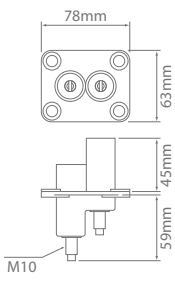

JS001

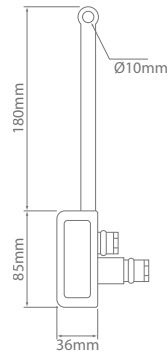

JS001-PC

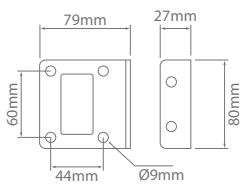

JS002

## Jump Start Connector – 70mm<sup>2</sup>

Part No.	Description	Material
JS000	Plug	High impact ABS plastic
JS001	Receptacle	High impact ABS plastic
JS001-PC	Protective Cover	PVC
JS002	Bracket	Powder-coated Aluminium

# High Current

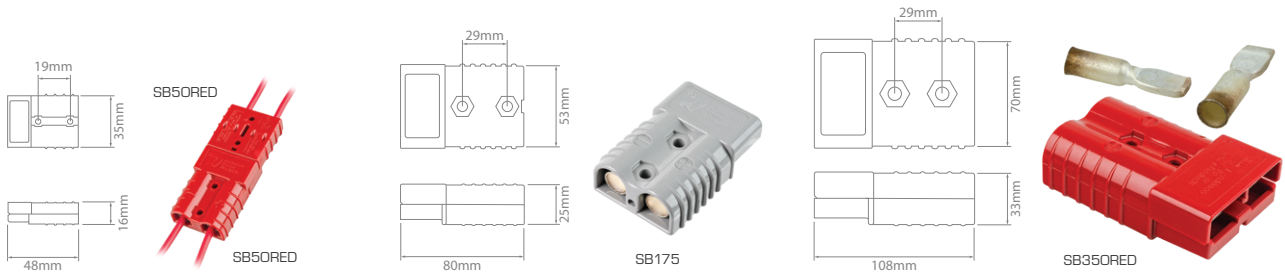

## High Current Connectors

	Colour		Current Rating (A)	Cable Size	
	Red	Grey		AWG	mm <sup>2</sup>
<b>SB50RED</b>	SB50	SB50BLUE <span>NEW</span>	50	6	13.3
<b>SB175RED</b>	SB175	—	175	1/0	53.5
—	SB175-35	—	175	2	38
<b>SB350RED</b>	SB350	—	350	2/0	67.4
—	SB350-50	—	350	1/0	53.5

Red, grey & blue models are keyed differently to avoid mismatching.



## High Current Connectors – Covers

	PVC			Polycarbonate	
	Red	Black	Grey	Red	Black
50A	<b>SB50-PC</b>	<b>SB50-PC-BLK</b>	<b>SB50-PC-GREY</b> <span>NEW</span>	<b>SB50-PC2R</b> <span>NEW</span>	<b>SB50-PC2B</b> <span>NEW</span>
175A	<b>SB175-PC</b>	—	—	—	<b>SB175-PC2</b>
350A	<b>SB350-PC</b>	—	—	—	<b>SB350-PC2</b>

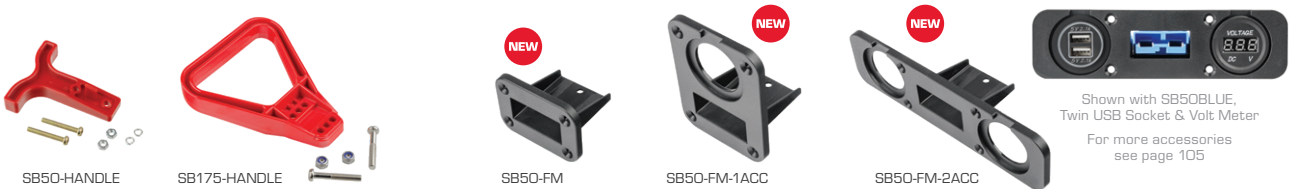

Shown with SB50BLUE, Twin USB Socket & Volt Meter  
For more accessories see page 105

## High Current Connectors – Accessories

Part No.	Description	Suits	Note
<b>SB50-HANDLE</b>	Handle kit, includes fitting hardware	50A connectors	
<b>SB175-HANDLE</b>	Handle kit, includes fitting hardware	175A connectors*	*Suits 350A connectors with appropriate nuts & bolts (user supplied).
<b>SB50-FM</b> <span>NEW</span>	Flange mount bracket	50A connectors	
<b>SB50-FM-1ACC</b> <span>NEW</span>	Flange mount bracket, one 30mm accessory cutout	50A connectors	
<b>SB50-FM-2ACC</b> <span>NEW</span>	Flange mount bracket, two 30mm accessory cutouts	50A connectors	



# High Current

## Junction Blocks



- Provides ground or power connection points for AC or DC circuits.
- Hard wearing thermoplastic housings on most models.
- Blocks with up to 12 terminals available.
- Heavy duty Single Stud models up to 400A.
- Numbered terminals on Multiple Stud models.
- Ideal for vehicle electrical systems, transformers, communication and computer power sections.

**Base :** Flexible Junction Blocks Thermoplastic Polymer  
**Operating Temperature :** Flexible Junction Blocks 120°C max. 80°C max.

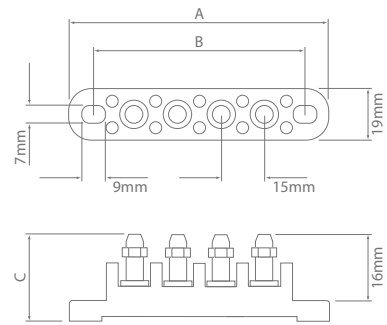

### Multiple Stud

Part No.	Circuits	Stud Ø (mm)	A (mm)	B (mm)	C (mm)
C5237-1	1	4.6	51	31	30
C5237-2	2	4.6	67	47	30
C5237-4	4	4.6	99	79	30
C5237-5	5	4.6	115	95	30
C4559-5 *	5	4.6	133	113	27
C5237-6	6	4.6	130	110	30
C5237-8	8	4.6	162	142	30
C5237-12	12	4.6	225	205	30

30A per terminal.

\* Supplied with star washers. This model has insulated wall barriers.

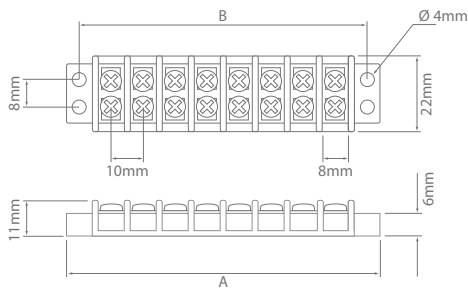

TB106



TB108

## Double Row Terminal Blocks

Part No.	Circuits	Screw Ø (mm)	A (mm)	B (mm)
<b>TB102</b>	2	3.4	36	28
<b>TB104</b>	4	3.4	55	48
<b>TB106</b>	6	3.4	74	67
<b>TB108</b>	8	3.4	93	85
<b>TB110</b>	10	3.4	112	104

30A per terminal.



1152

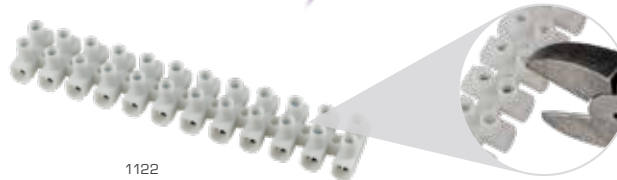
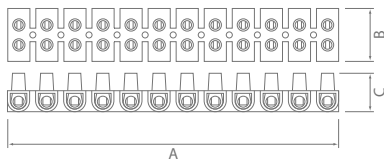
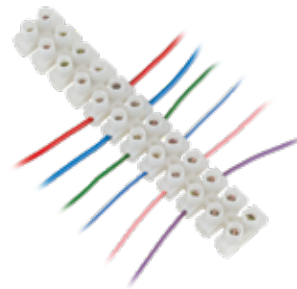

Can be cut into separate sections

1122

## Flexible Junction Blocks

Part No.	Circuits	Current Rating (A)	Cable Size (mm <sup>2</sup> )	Volts	Hole Size (mm)	A (mm)	B (mm)	C (mm)
<b>1102</b>	12	6	4	400	3.3	94	17	12
<b>1122</b>	12	15	8	400	4.5	140	23	19
<b>1142</b>	12	30	10	400	5.6	157	25	25
<b>1152</b>	12	60	16	400	6.6	200	32	24



# High Current

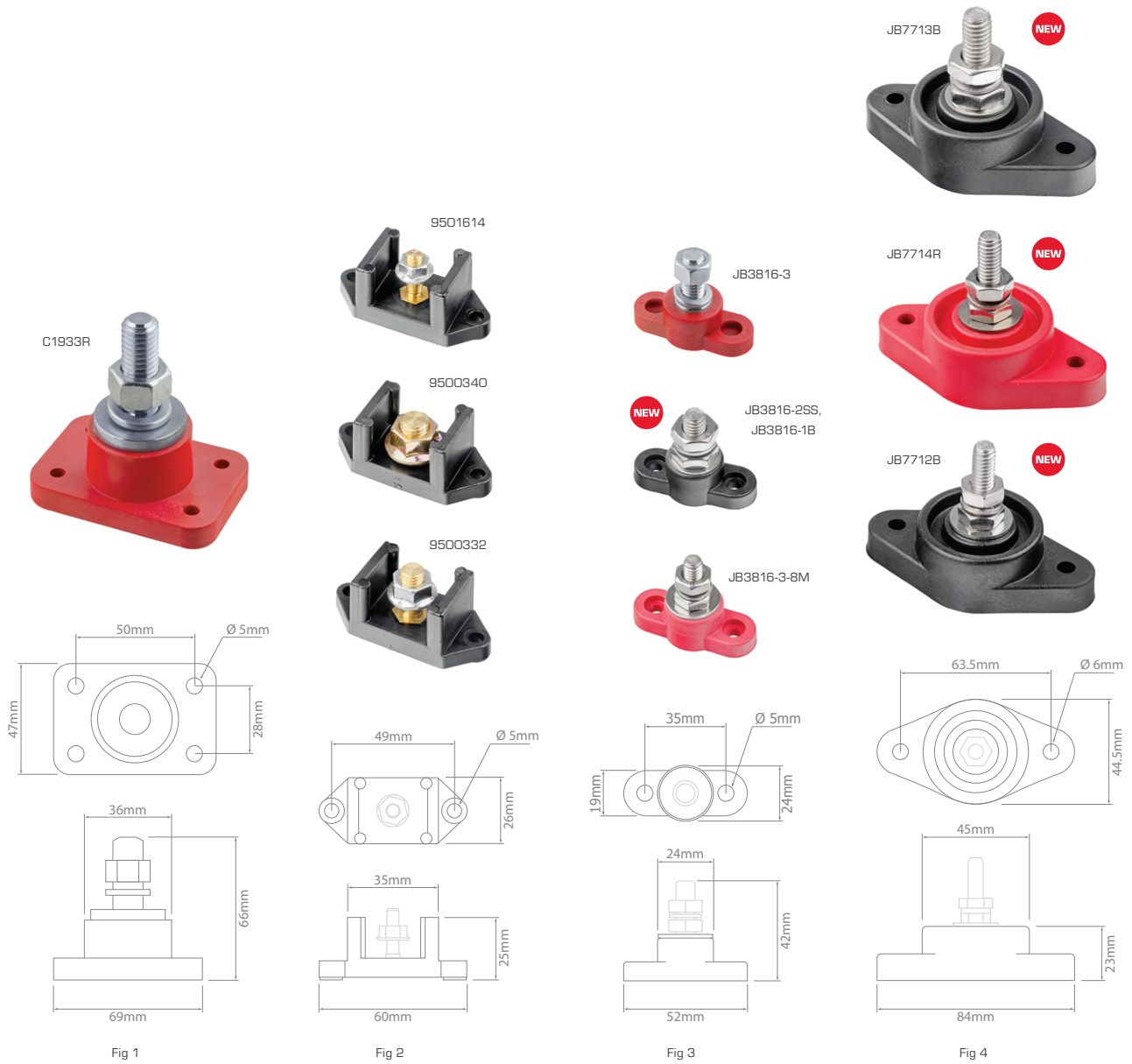

## Single Stud

Colour	Hardware	Current Rating (A)	Stud (Inches)	Stud (mm)	Stud Height (mm)	Fig
Red <b>C1933R</b>	Black <b>C1933</b> Plated Steel	400	1/2" 13 UNC	—	38	1
—	<b>9500340</b> Plated Brass	250	—	10-1.5	14	2
—	<b>9500332</b> Plated Brass	200	—	8-1.25	19	2
—	<b>9501614</b> Plated Brass	100	—	6-1	19	2
<b>JB3816-3</b>	<b>JB3816-2</b> Plated Steel	250	3/8" 16 UNC	—	22	3
<b>JB3816-3SS</b> <b>NEW</b>	<b>JB3816-2SS</b> <b>NEW</b> Stainless Steel	240	3/8" 16 UNC	—	22	3
<b>JB3816-3-8M</b>	<b>JB3816-2-8M</b> Stainless Steel	200	5/16" 18 UNC	—	22	3
<b>JB3816-1R</b> <b>NEW</b>	<b>JB3816-1B</b> <b>NEW</b> Stainless Steel	160	1/4" 20 UNC	—	22	3
<b>JB7713R</b>	<b>JB7713B</b> <b>NEW</b> Stainless Steel	240	3/8" 16 UNC	—	54	4
<b>JB7714R</b> <b>NEW</b>	<b>JB7714B</b> <b>NEW</b> Stainless Steel	160	5/16" 18 UNC	—	30	4
<b>JB7712R</b>	<b>JB7712B</b> <b>NEW</b> Stainless Steel	150	1/4" 20 UNC	—	52	4



C1925

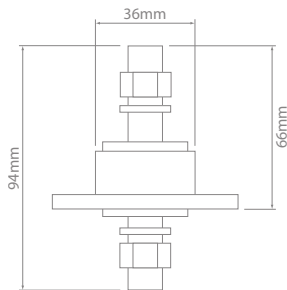
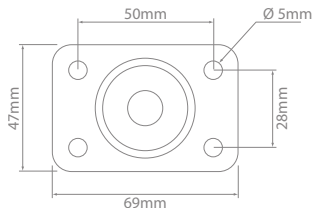

Fig 1



C1938

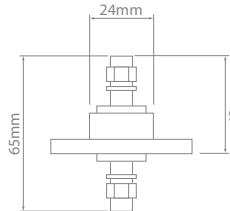
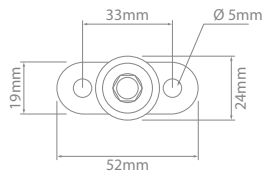

Fig 2



C2791

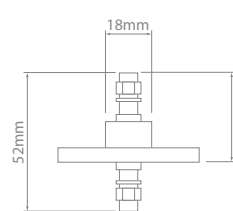
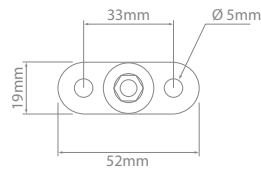

Fig 3



C2909

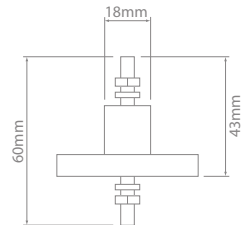
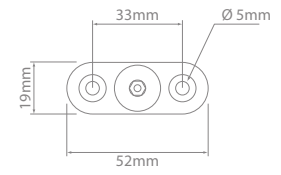
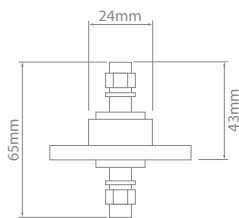
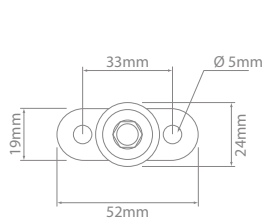

Fig 4

## Single Stud – Feed Through – Copper Alloy

Colour	Current Rating (A)	Stud (Inches)	Fig	
Red <b>C1925</b>	Black <b>C1925B</b>	400	1/2" 13 UNC	1
<b>C1938R</b>	<b>C1938</b>	250	3/8" 16 UNC	2
<b>C1938-1R</b>	<b>C1938-1</b>	200	5/16" 18 UNC	2
<b>C2791R</b>	<b>C2791</b>	100	1/4" 20 UNC	3
—	<b>C2909</b>	100	1/4" 20 UNC	4



### Blue Dot – Enhanced Performance



Certain components feature brass or plated brass material and are marked with a blue mark. These components pass current more efficiently than steel. Ensure blue dot components are kept in their correct conductive location (factory location). Failure to do so can result in degraded performance and premature device failure.



## Single Stud – Feed Through – Stainless Steel



Colour	Current Rating (A)	Stud (Inches)	Stud (mm)	
Red <b>JB7720R</b> <span style="color:red">NEW</span>	Black <b>JB7720B</b> <span style="color:red">NEW</span>	250	—	8-1.25
<b>JB7723R</b> <span style="color:red">NEW</span>	<b>JB7723B</b> <span style="color:red">NEW</span>	250	3/8" 16 UNC	—
<b>JB7722R</b> <span style="color:red">NEW</span>	<b>JB7722B</b> <span style="color:red">NEW</span>	250	1/4" 20 UNC	—





# High Current

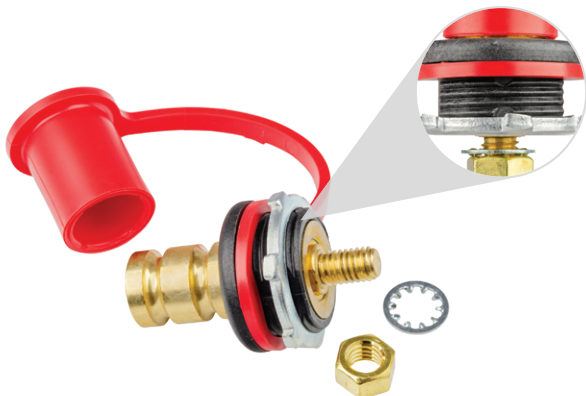

M46210-02

Suits panels up to 9mm



M46210-03

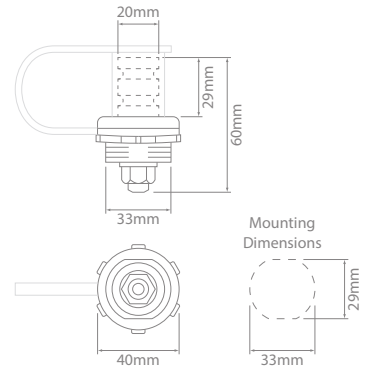

Mounting Dimensions

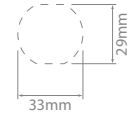

**NEW**

Suits panels up to 9mm



M46211-01

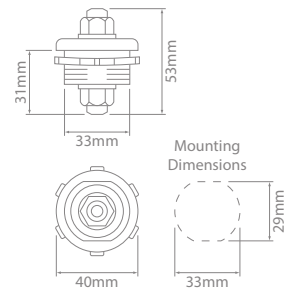

Mounting Dimensions

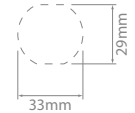

## Battery Jumper Terminals

Colour	Stud (Inches)	Max Panel Size (mm)
Red	3/8" 16 UNC	9
Black	3/8" 16 UNC	9

**M46210-02**

**M46210-03**

**NEW**

**M46211-01**

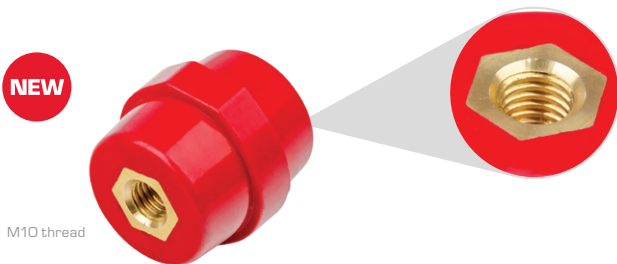

M10 thread

M10 thread

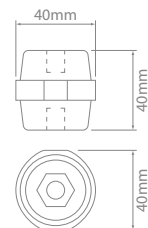

## Insulated Standoff **NEW**

Part No.	Insulator Voltage (Kv)	Screw Thread
<b>JB40-M10</b>	10	M10 thread

- Create reliable, trouble-free circuit paths to control systems.
- Hook up positive/negative return lines to a single cable.
- Eight stainless steel #8-32 connection screws.
- Hard wearing glass-filled nylon.
- Blue Dot enhanced conductivity componentry.

**NEW**

Junction Block – 8 Point



Post : Stainless Steel  
Base : Glass-filled Nylon

## Blue Dot – Enhanced Performance Blue Dot

The 8 Point Junction Blocks feature brass or plated brass material and are marked with a blue mark. These components pass current more efficiently than steel. Ensure blue dot components are kept in their correct conductive location (factory location). Failure to do so can result in degraded performance and premature device failure.

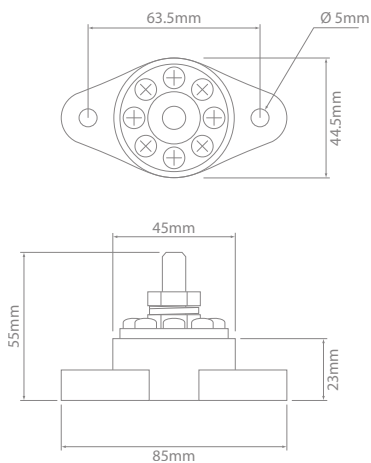

## Junction Block – 8 Point NEW

Colour	Current Rating (A)	Stud (Inches)	Stud Height (mm)
Red <b>JB77837R</b>	160	3/8" 16 UNC	55
Black <b>JB77837B</b>			

